

SPECIFICATIONS
 AREA OPTIONS | DIMENSIONS | CAPACITIES

**SIZE
 DOES MATTER
 SO DOES SIZE**

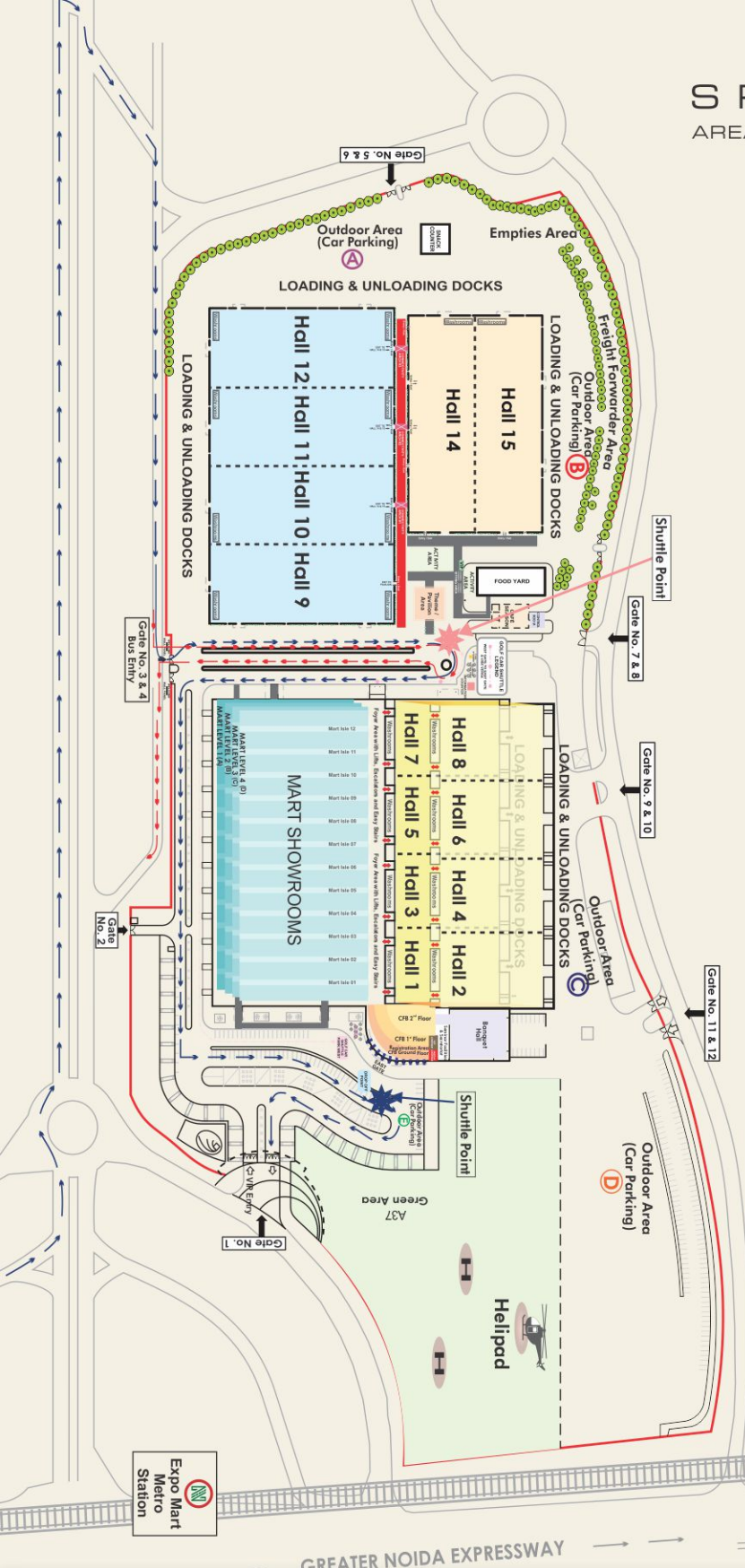

Pari Chowk Metro Station

JAYPEE GOLF COURSE
 (Awarded - 18 hole co)

AREAS AVAILABLE ON GROUND FLOOR

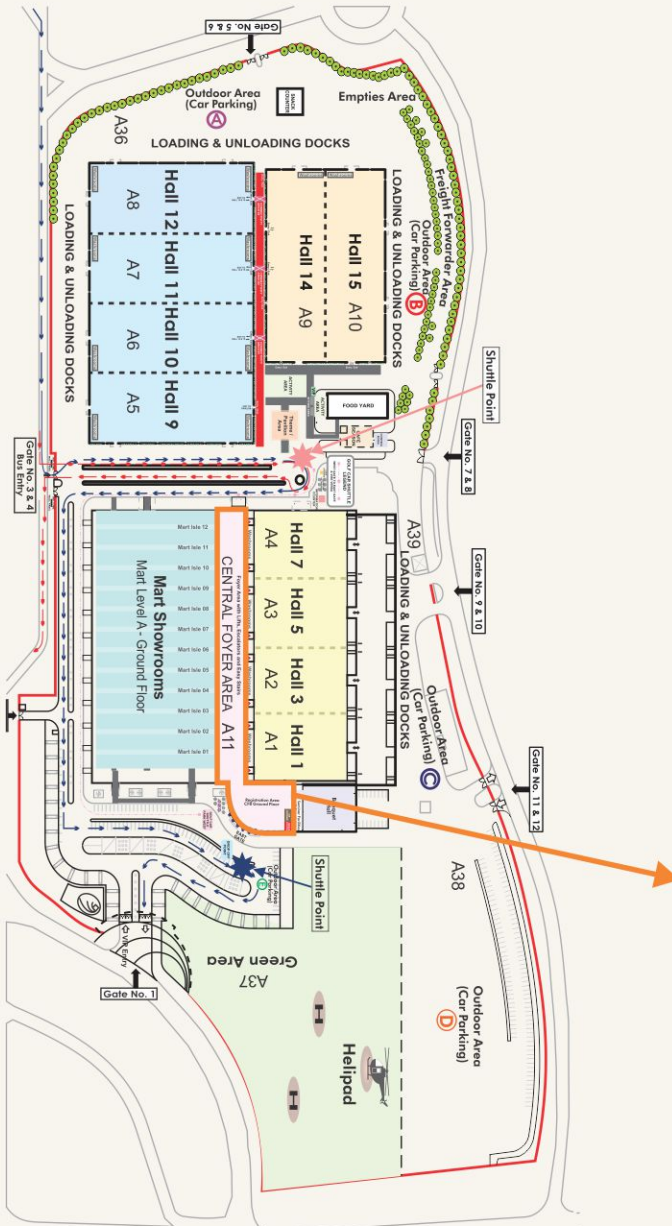

GROUND FLOOR CFB AREAS (CFB - CENTRAL FUNCTION BUILDING)

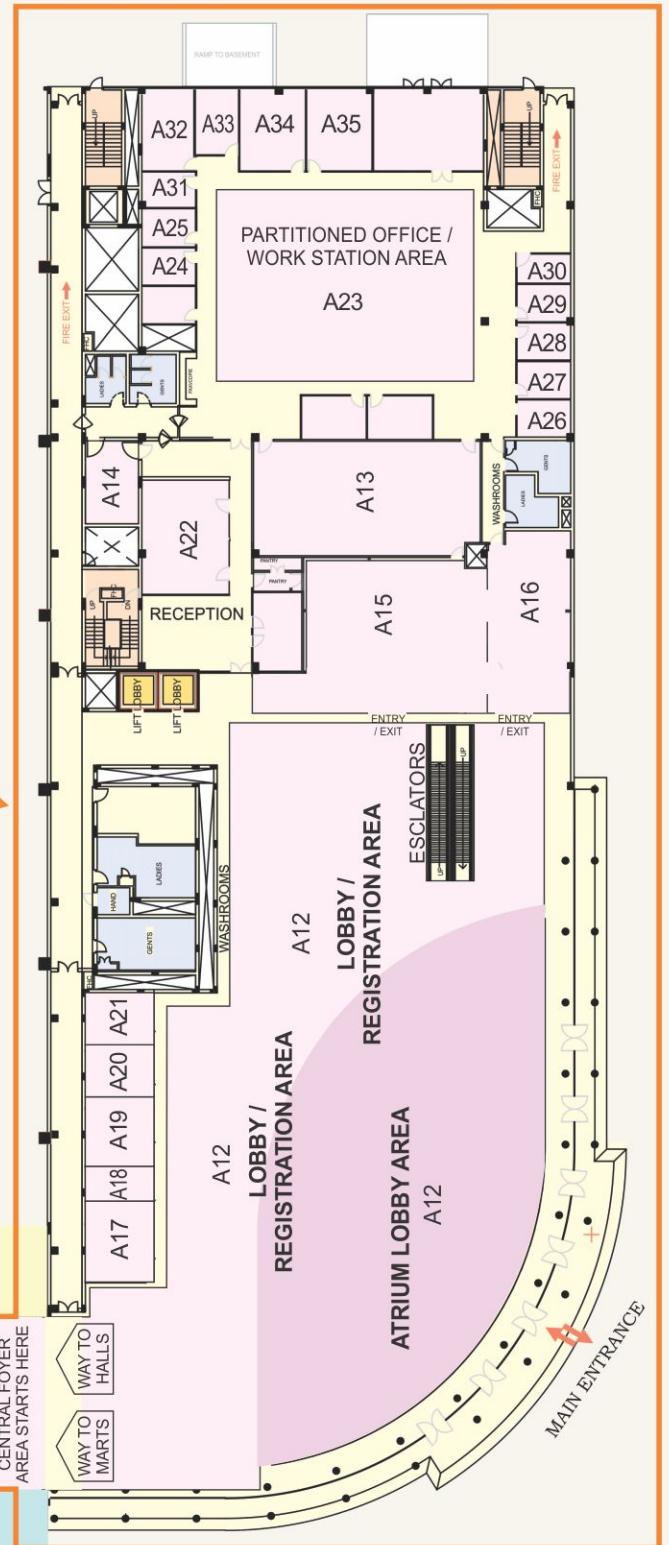

Hall 7 Hall 5 Hall 3 Hall 1

CENTRAL FOYER AREA A11

Mart Isle 11 Mart Isle 10 Mart Isle 09 Mart Isle 08 Mart Isle 07 Mart Isle 06 Mart Isle 05 Mart Isle 04 Mart Isle 03 Mart Isle 02 Mart Isle 01

Mart Level A - Ground Floor

WAY TO HALLS
WAY TO MARTS

GROUND FLOOR

| Facility | Area No. # | Load Bearing (in Kgs) | Area (in Square Metres) | Area (in Square Feet) | Ceiling Height (in Metres) | Ceiling Height (in Feet) | Dimension (in Metres) | Theatre Seating | Classroom Seating | U-Shape Seating | Banquet Seating | Cocktail Seating |
|--|------------|-----------------------|-------------------------|-----------------------|----------------------------|--------------------------|-------------------------------------|-----------------|-------------------|-----------------|-----------------|------------------|
| Multipurpose Hall 1 | A1 | 1,500 | 3,456 | 37,200 | 5.3 | 17.4 | 72 x 48 | 3,250 | 1,920 | 1,200 | 2,000 | 3,500 |
| Multipurpose Hall 3 | A2 | 1,500 | 3,456 | 37,200 | 5.3 | 17.4 | 72 x 48 | 3,250 | 1,920 | 1,200 | 2,000 | 3,500 |
| Multipurpose Hall 5 | A3 | 1,500 | 3,456 | 37,200 | 5.3 | 17.4 | 72 x 48 | 3,250 | 1,920 | 1,200 | 2,000 | 3,500 |
| Multipurpose Hall 7 | A4 | 1,500 | 3,456 | 37,200 | 5.3 | 17.4 | 72 x 48 | 3,250 | 1,920 | 1,200 | 2,000 | 3,500 |
| Multipurpose Hall 9 | A5 | 30,000 | 6,250 | 67,250 | 9 | 29.25 | 125 x 50 | 5,875 | 3,467 | 2,167 | 3,850 | 6,000 |
| Multipurpose Hall 10 | A6 | 30,000 | 6,250 | 67,250 | 9 | 29.25 | 125 x 50 | 5,875 | 3,467 | 2,167 | 3,850 | 6,000 |
| Multipurpose Hall 11 | A7 | 30,000 | 6,250 | 67,250 | 9 | 29.25 | 125 x 50 | 5,875 | 3,467 | 2,167 | 3,850 | 6,000 |
| Multipurpose Hall 12 | A8 | 30,000 | 6,250 | 67,250 | 14 | 45.5 | 125 x 50 | 5,875 | 3,467 | 2,167 | 3,850 | 6,000 |
| Multipurpose Hall 14 | A9 | 30,000 | 6,120 | 65,875 | 9 | 29.25 | 136 x 45 | 5,875 | 3,467 | 2,167 | 3,850 | 6,000 |
| Multipurpose Hall 15 | A10 | 30,000 | 6,120 | 65,875 | 9 | 29.25 | 136 x 45 | 5,875 | 3,467 | 2,167 | 3,850 | 6,000 |
| Central Foyer Area | A11 | 750 | 1,675 | 18,027 | 15 | 49.2 | 192.50 x 8.70 | - | - | - | 1,500 | 1,600 |
| Central Function Building | A12 | 750 | 1,164 | 12,533 | - | - | 46.300 x 28.85 | - | - | - | 1,000 | 1,100 |
| Board Room | A13 | 750 | 110 | 1,184 | 3.2 | 10.4 | 14.90 x 6.95 | - | - | 42 | - | - |
| Mini Conference Room | A14 | 750 | 21 | 221 | 3.2 | 10.4 | 5.7 x 3.6 | - | - | 18 | - | - |
| VIP Lounge | A15 | 750 | 108 | 1,163 | 3.2 | 10.4 | 11.270 x 8.350 | 80 | 40 | 40 | 100 | 125 |
| Media Lounge | A16 | 750 | 62 | 663 | 3.2 | 10.4 | 9.330 x 5.820 | 50 | 25 | 15 | 50 | 75 |
| Glass Cubicle 01 | A17 | 750 | 30 | 319 | 3.2 | 10.4 | 4.710 x 3.810 | 15 | 8 | 8 | - | - |
| Glass Cubicle 02 | A18 | 750 | 12 | 133 | 3.2 | 10.4 | 4.710 x 3.810 | 8 | 4 | 4 | - | - |
| Glass Cubicle 03 | A19 | 750 | 25 | 265 | 3.2 | 10.4 | 4.710 x 5.150 | 12 | 6 | 6 | - | - |
| Glass Cubicle 04 | A20 | 750 | 18 | 198 | 3.2 | 10.4 | 4.710 x 2.530 | 10 | 5 | 5 | - | - |
| Glass Cubicle 05 | A21 | 750 | 18 | 195 | 3.2 | 10.4 | 4.710 x 6.220 | 10 | 5 | 5 | - | - |
| Spectra Cabins | A22 | 750 | 120 | 1,292 | 3.2 | 10.4 | 3.72 x 2.65 | - | 12 | - | - | - |
| Secretariat & Officer's Cabin : 12 No. | A23 | 750 | 240 | 2,583 | 3.2 | 10.4 | a) 5.940 x 4.350 & b) 5.940 x 4.120 | - | - | - | - | - |
| IEML Officer's Cabins 01 | A24 | 750 | 9.49 | 102.11 | 3.2 | 10.4 | 3.65 x 2.6 | - | - | - | - | - |
| IEML Officer's Cabins 02 | A25 | 750 | 9.85 | 105.98 | 3.2 | 10.4 | 3.72 x 2.65 | - | - | - | - | - |
| IEML Officer's Cabins 03 | A26 | 750 | 9.74 | 104.8 | 3.2 | 10.4 | 3.72 x 2.62 | - | - | - | - | - |
| IEML Officer's Cabins 04 | A27 | 750 | 14.60 | 157.09 | 3.2 | 10.4 | 4.48 x 3.26 | - | - | - | - | - |
| IEML Officer's Cabins 05 | A28 | 750 | 14.34 | 154.29 | 3.2 | 10.4 | 4.54 x 3.16 | - | - | - | - | - |
| IEML Officer's Cabins 06 | A29 | 750 | 9.72 | 104.58 | 3.2 | 10.4 | 3.71 x 2.62 | - | - | - | - | - |
| IEML Officer's Cabins 07 | A30 | 750 | 9.49 | 102.11 | 3.2 | 10.4 | 3.71 x 2.56 | - | - | - | - | - |
| IEML Officer's Cabins 08 | A31 | 750 | 9.83 | 105.77 | 3.2 | 10.4 | 3.71 x 2.65 | - | - | - | - | - |
| IEML Officer's Cabins 09 | A32 | 750 | 21.82 | 234.78 | 3.2 | 10.4 | 5.79 x 3.77 | - | - | - | - | - |
| IEML Officer's Cabins 10 | A33 | 750 | 12.99 | 139.77 | 3.2 | 10.4 | 4.69 x 2.77 | - | - | - | - | - |
| IEML Officer's Cabins 11 | A34 | 750 | 23.63 | 254.25 | 3.2 | 10.4 | 5.51 x 4.29 | - | - | - | - | - |
| IEML Officer's Cabins 12 | A35 | 750 | 24.83 | 267.17 | 3.2 | 10.4 | 5.79 x 4.29 | - | - | - | - | - |

OUTDOOR AREA - GROUND FLOOR

| Facility | Area No. # | Load Bearing (in Kgs) | Area (in Square Metres) | Area (in Square Feet) | Ceiling Height (in Metres) | Ceiling Height (in Feet) | Dimension (in Metres) | Theatre Seating | Classroom Seating | U-Shape Seating | Banquet Seating | Cocktail Seating |
|----------------------------------|------------|-----------------------|-------------------------|-----------------------|----------------------------|--------------------------|-----------------------|-----------------|-------------------|-----------------|-----------------|------------------|
| Additional Open Area at OBC Bank | A36 | | 25,000 | 269,097 | NA | NA | - | - | - | | | |
| Lawn | A37 | | 33,611 | 361,786 | NA | NA | | | | 15,000 | 18,000 | |
| Paved Area - | | | | | | | | | | | | |
| Near Gate No. 12 | A38 | | 14,585 | 156,992 | NA | NA | | | | 10,000 | 12,000 | |
| Near Gate No. 8 & 9 | A39 | | 19,846 | 213,621 | NA | NA | | | | 15,000 | 20,000 | |

AREAS AVAILABLE ON FIRST FLOOR



Mart Level B - First Floor

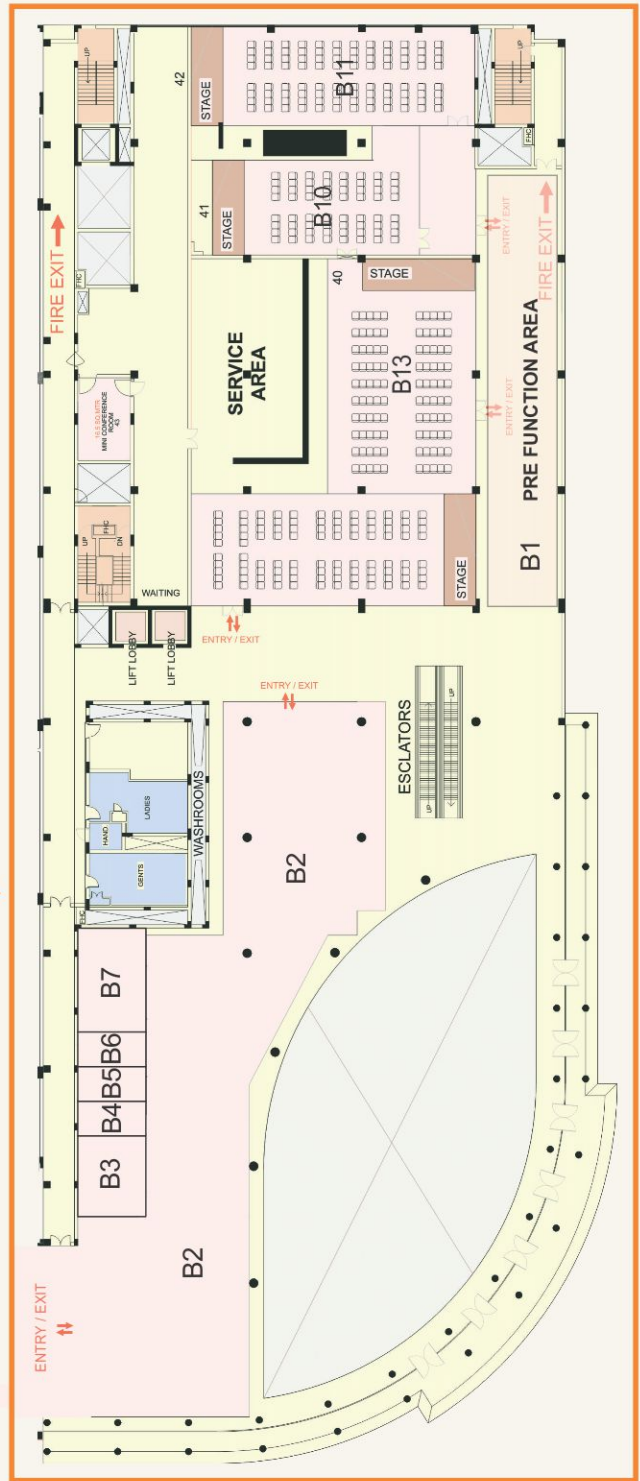

FIRST FLOOR

| Facility | Area No. # | Load Bearing (in Kgs) | Area (in Square Metres) | Area (in Square Feet) | Ceiling Height (in Metres) | Ceiling Height (in Feet) | Dimension (in Metres) | Theatre Seating | Classroom Seating | U-Shape Seating | Banquet Seating | Cocktail Seating |
|-----------------------------|------------|-----------------------|-------------------------|-----------------------|----------------------------|--------------------------|----------------------------------|-----------------|-------------------|-----------------|-----------------|------------------|
| Pre-function Area | B1 | 750 | 245 | 2,640 | 3.3 | 10.72 | 206.220 x 3.950 | – | – | – | 125 | 150 |
| CFB Lobby Area | B2 | 750 | 1,028 | 11,066 | 3.2 | 10.4 | 34.470 x 8.200 & 22.450 x 24.420 | – | – | – | 950 | 1,025 |
| Glass Cubicle 06 | B3 | 750 | 28 | 301 | 3.2 | 10.4 | 6.1 x 4.7 | 16 | 16 | 12 | – | 25 |
| Glass Cubicle 07 | B4 | 750 | 12 | 129 | 3.2 | 10.4 | 4.6 x 2.6 | 8 | 8 | 6 | – | 10 |
| Glass Cubicle 08 | B5 | 750 | 12 | 129 | 3.2 | 10.4 | 4.6 x 2.6 | 8 | 8 | 6 | – | 10 |
| Glass Cubicle 09 | B6 | 750 | 12 | 129 | 3.2 | 10.4 | 4.6 x 2.6 | 8 | 8 | 6 | – | 10 |
| Glass Cubicle 10 | B7 | 750 | 36 | 388 | 3.2 | 10.4 | 7.7 x 4.7 | 30 | 30 | 15 | 18 | 24 |
| Glass Cubicle | B8 | 750 | 144 | 1,550 | 3.2 | 10.4 | 12 x 12 | 135 | 80 | 50 | 140 | 150 |
| Glass Cubicle | B9 | 750 | 144 | 1,550 | 3.2 | 10.4 | 12 x 12 | 135 | 80 | 50 | 140 | 150 |
| Dining (Divisible into two) | B10 | 750 | 294 | 3,169 | 3.3 | 10.72 | 39.10 x 19.6 | 250 | 150 | 50 | 200 | 250 |
| Dining A | B10a | 750 | 136 | 1,463 | 3.3 | 10.72 | 19.4 x 7 | 128 | 77 | 48 | 135 | 150 |
| Dining B | B10b | 750 | 136 | 1,463 | 3.3 | 10.72 | 19.4 x 7 | 128 | 77 | 48 | 135 | 150 |
| Restaurant | B11 | 750 | 470 | 5,063 | 3.3 | 10.72 | 15.1 x 19.5 | 300 | 150 | 100 | 300 | 350 |
| Restaurant A | B12 | 750 | 147 | 1,578 | 3.3 | 10.72 | 19.3 x 7.6 | 138 | 83 | 52 | 140 | 150 |
| Restaurant B | B13 | 750 | 135 | 1,453 | 3.3 | 10.72 | 16 x 8.4 | 127 | 76 | 48 | 130 | 140 |

AREAS AVAILABLE ON SECOND FLOOR

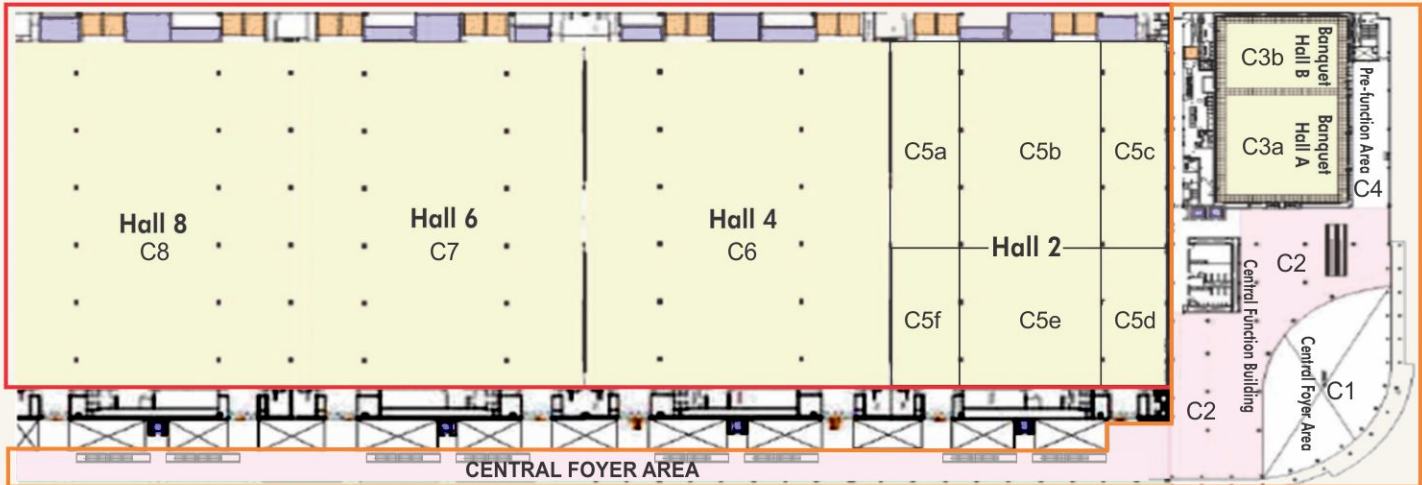
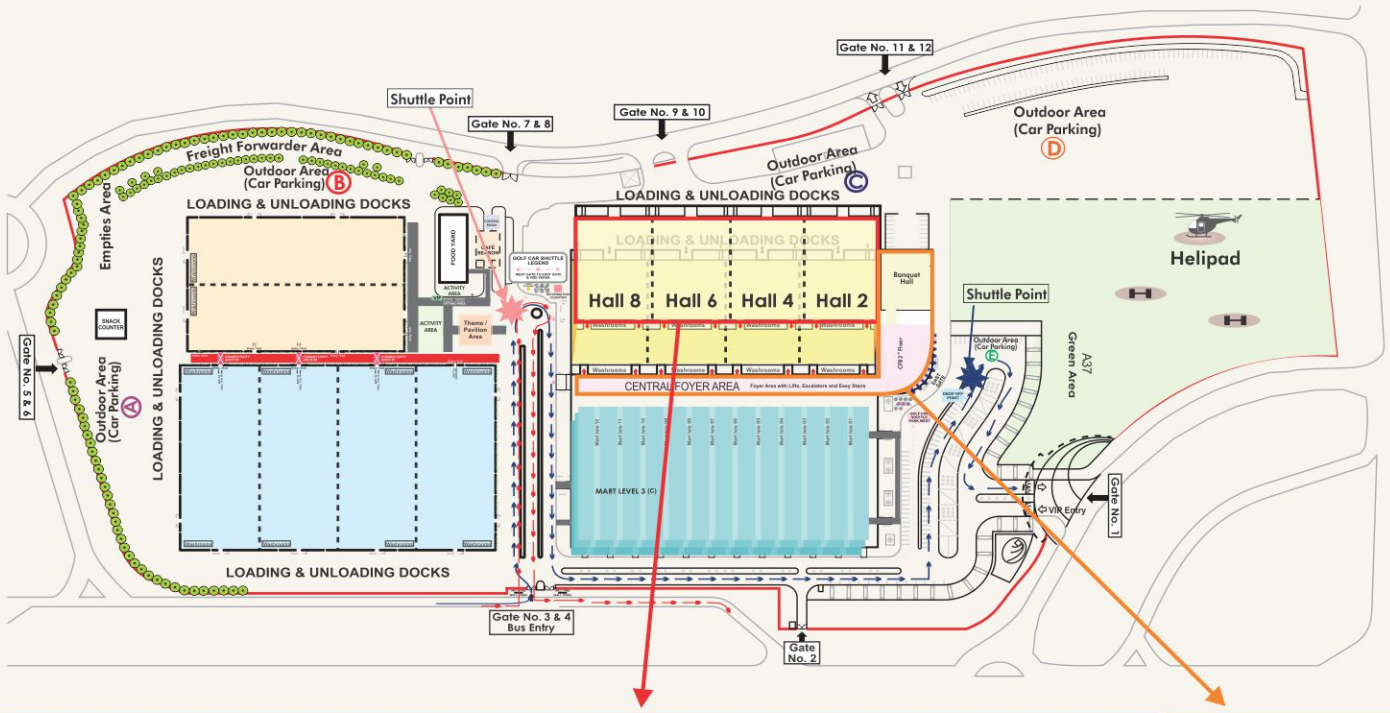

SECOND FLOOR

| Facility | Area No. # | Load Bearing (in Kgs) | Area (in Square Metres) | Area (in Square Feet) | Ceiling Height (in Metres) | Ceiling Height (in Feet) | Dimension (in Metres) | Theatre Seating | Classroom Seating | U-Shape Seating | Banquet Seating | Cocktail Seating |
|---|------------|-----------------------|-------------------------|-----------------------|----------------------------|--------------------------|-------------------------------------|-----------------|-------------------|-----------------|-----------------|------------------|
| Central Foyer Area | C1 | 750 | 157 | 1,686 | 15 | 49.2 | – | – | – | – | 125 | 150 |
| CFB Lobby Area | C2 | 750 | 1,028 | 11,066 | 15 | 49.2 | 34.470 x 8.200 & 22.450 x 24.420 | – | – | – | 950 | 1025 |
| Banquet Hall (Divisible into two) | C3 | 750 | 798 | 8,587 | 8 | 26.2 | 40x20 | 750 | 350 | 300 | 470 | 800 |
| Banquet Hall A | C3a | 750 | 482 | 5,189 | 8 | 26.2 | 25x20 | 400 | 200 | 150 | 280 | 400 |
| Banquet Hall B | C3b | 750 | 316 | 3,398 | 8 | 26.2 | 15x20 | 300 | 150 | 100 | 190 | 300 |
| Banquet Hall with Pre-function Area | C3+ C4 | 750 | 245 | 2,640 | NA | NA | NA | NA | NA | NA | NA | NA |
| Multipurpose Hall 2 (Divisible into 6) | C5 | 750 | 3,456 | 37,200 | 5.7 | 18.52 | 72 x 48 | 3,250 | 1,920 | 1,200 | 2,000 | 3,500 |
| Hall A | C5a | 750 | 432 | 4,648 | 5.7 | 18.52 | 36 x 12 | 406 | 244 | 152 | 425 | 437 |
| Hall B | C5b | 750 | 864 | 9,297 | 5.7 | 18.52 | 36 x 24 | 812 | 487 | 305 | 850 | 875 |
| Hall C | C5c | 750 | 432 | 4,648 | 5.7 | 18.52 | 36 x 12 | 406 | 244 | 152 | 425 | 437 |
| Hall D | C5d | 750 | 288 | 3,099 | 5.7 | 18.52 | 24 x 12 | 271 | 162 | 102 | 283 | 292 |
| Hall E | C5e | 750 | 576 | 6,198 | 5.7 | 18.52 | 24 x 24 | 541 | 325 | 203 | 567 | 583 |
| Hall F | C5f | 750 | 288 | 3,099 | 5.7 | 18.52 | 24 x 12 | 271 | 162 | 102 | 283 | 292 |
| Multipurpose Hall 4 | C6 | 750 | 3,456 | 37,200 | 5.7 | 18.52 | 72 x 48 | 3,250 | 1,920 | 1,200 | 2,000 | 3,500 |
| Multipurpose Hall 6 | C7 | 750 | 3,456 | 37,200 | 5.7 | 18.52 | 72 x 48 | 3,250 | 1,920 | 1,200 | 2,000 | 3,500 |
| Multipurpose Hall 8 | C8 | 750 | 3,456 | 37,200 | 5.7 | 18.52 | 72 x 48 | 3,250 | 1,920 | 1,200 | 2,000 | 3,500 |

THIRD FLOOR

| Facility | Area No. # | Load Bearing (in Kgs) | Area (in Square Metres) | Area (in Square Feet) | Ceiling Height (in Metres) | Ceiling Height (in Feet) | Dimension (in Metres) | Theatre Seating | Classroom Seating | U-Shape Seating | Banquet Seating | Cocktail Seating |
|----------------|------------|-----------------------|-------------------------|-----------------------|----------------------------|--------------------------|-----------------------|-----------------|-------------------|-----------------|-----------------|------------------|
| Restaurant | D1 | 750 | 190 | 190 | 2,042 | 3.3 | 21.7 x 7.7 | - | - | - | 125 | 150 |
| Food Court | D2 | 750 | 764 | 764 | 8,224 | - | 38.2 x 20 | 500 | 250 | 200 | 700 | 750 |
| Glass Cubicle | D3 | 750 | 70 | 70 | 753 | 3.3 | | 66 | 39 | 25 | 69 | 71 |
| Glass Cubicle | D4 | 750 | 70 | 70 | 753 | 3.3 | | 66 | 39 | 25 | 69 | 71 |
| Glass Cubicle | D5 | 750 | 50 | 50 | 538 | 3.3 | | 47 | 28 | 18 | 49 | 51 |
| Glass Cubicle | D6 | 750 | 160 | 160 | 1,722 | 3.3 | | 150 | 90 | 56 | 157 | 162 |
| Glass Cubicle | D7 | 305 | 305 | 3,282 | 3.3 | 3.3 | 287 | 172 | 108 | 300 | 309 | - |
| Glass Cubicle | D8 | 45 | 45 | 484 | 3.3 | 3.3 | 42 | 25 | 16 | 44 | 46 | - |
| Glass Cubicle | D9 | 95 | 95 | 1,022 | 3.3 | 3.3 | 89 | 54 | 33 | 93 | 96 | - |
| Glass Cubicle | D10 | 158 | 158 | 1,700 | 3.3 | 3.3 | 149 | 89 | 56 | 155 | 160 | - |
| Glass Cubicle | D11 | 212 | 212 | 2,281 | 3.3 | 3.3 | 199 | 120 | 75 | 209 | 215 | - |
| VIP Lounge | D12 | 133 | 133 | 1,431 | 3.3 | 3.3 | 100 | 50 | 50 | 100 | 125 | - |
| Meeting Room A | D13 | 18 | 18 | 194 | 3.3 | 3.3 | - | - | 10 | - | - | - |
| Meeting Room B | D14 | 19 | 48 | 204 | 3.3 | 3.3 | - | - | 10 | - | - | - |
| Meeting Room C | D15 | 8 | 8 | 86 | 3.3 | 3.3 | - | - | 5 | - | - | - |

AREAS AVAILABLE ON THIRD FLOOR

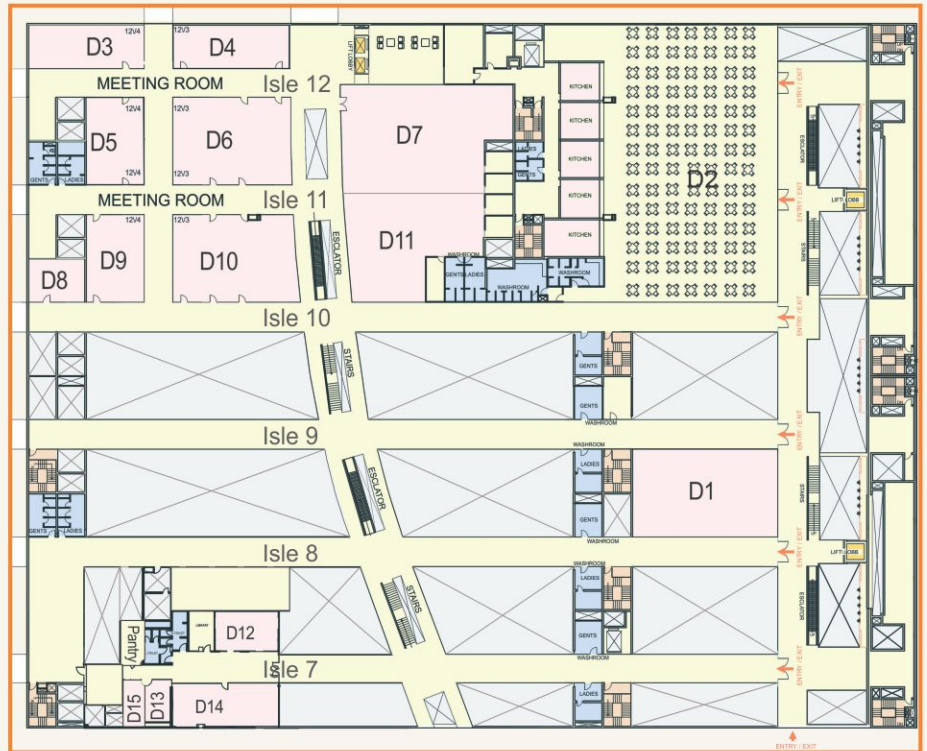
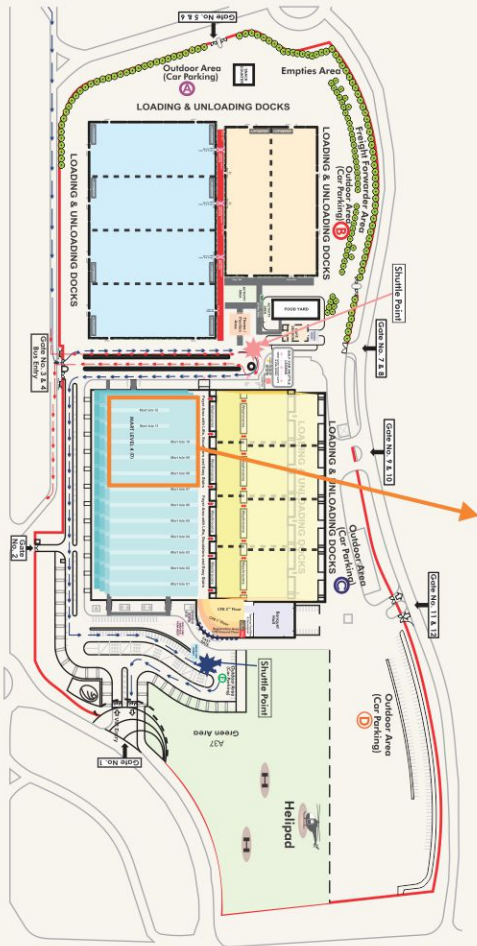

INDIA EXPOSITION MART LTD.

23-25 & 27-29, Knowledge Park-II, Greater Noida Expressway (UP), Delhi-NCR, India

Phone: +91-120-2328011-20 / 28; Fax: +91-120-2328010; Mobile: +91-9871387221, 9910300254, 9717790583

E-mail: vp@indiaexpocentre.com, marketing@indiaexpocentre.com; Web: www.indiaexpocentre.com